

# DRAWING ROOM TANNERY ARTS

## Hire our Spaces

**DRAWING ROOM  
TANNERY ARTS**

[drawingroom.org.uk/hire](http://drawingroom.org.uk/hire)

Tannery Arts CIO | Drawing Room  
Unit 1B New Tannery Way  
Bermondsey, London, SE1 5WS

[drawingroom.org.uk/hire](http://drawingroom.org.uk/hire)



# About us

## The place to discover contemporary drawing.

Tannery Arts CIO is a charity comprising a public gallery, Drawing Room, and affordable studio provider, Tannery Arts studios.

The Gallery champions the unlimited potential of drawing to help us understand ourselves, each other and our world, through **exhibitions**, **learning projects** and a unique **library**.

Read more about Drawing Room's work and mission at:  
**[drawingroom.org.uk/about-us](http://drawingroom.org.uk/about-us)**







Our newbuild premises at New Tannery Way is in the heart of Bermondsey, **just a 15-minute walk from London Bridge.**

As a charity, 90% of our income is self-generated, so all hires will support our activities, including our affordable studios, and Learning and Exhibition programmes.

Our spaces for hire include our flexible **Community Studio**, perfect for workshops and events – and our light-filled, double-height **Gallery**, available to hire between our own exhibitions.

Our expert **Events and Commercial Hires team** will work with you through every stage of your project, from planning to execution.

We are happy to arrange for a site visit to talk through your ideas.



# Community Studio





# Community Studio

## **72sqm / 60 standing capacity**

A flexible, 'messy' space for workshops, parties, public events, meetings, away days, photoshoots and branded events..

Our integrated AV system features a ceiling-mounted projector, microphones, speakers. A sink and art materials are available – perfect for workshops.

### Capacities:

- 60 Standing
- 40 Dinner
- 25 Boardroom
- 28 Cabaret





A photograph showing several children sitting around a table, engaged in drawing. They are using various colored markers and pencils on white paper. One child in the foreground is a young girl with long blonde hair, wearing a blue school uniform, sitting on a wooden chair and looking at her drawing. The table is covered with several open sketchbooks or papers, some showing completed drawings like a girl's face, a landscape with a tree, and abstract patterns. The background shows more children and papers, suggesting a busy art studio or classroom setting.

# Community Studio pricing

- Large charities and companies  
£150/hr, £1000/day
- Ticketed events, local private enterprises: £100/hr, £700/day
- Small community groups, Tannery artists, small/local charities:  
£50/hr, £350/day

Bookings up to 50 people require one dedicated staff member, charged £20/hour.

Bookings for 51+ people will require an additional staff member charged £20/hour (minimum four-hour shift) – also charged for bookings outside the Gallery's opening hours of 12–6pm.



# Gallery





# Gallery

## **115sqm / 250 standing capacity**

The Gallery is available to hire between our exhibitions, for projects including degree shows, artist exhibitions, installations, photoshoots, fashion shows, corporate events, brand activations, dinner and book launches. We are open to ideas!

Gallery hire includes:

- Main Gallery (10.8m × 12.2m), double-height
- Small Gallery (5.4m × 4.8m)





# Gallery dimensions

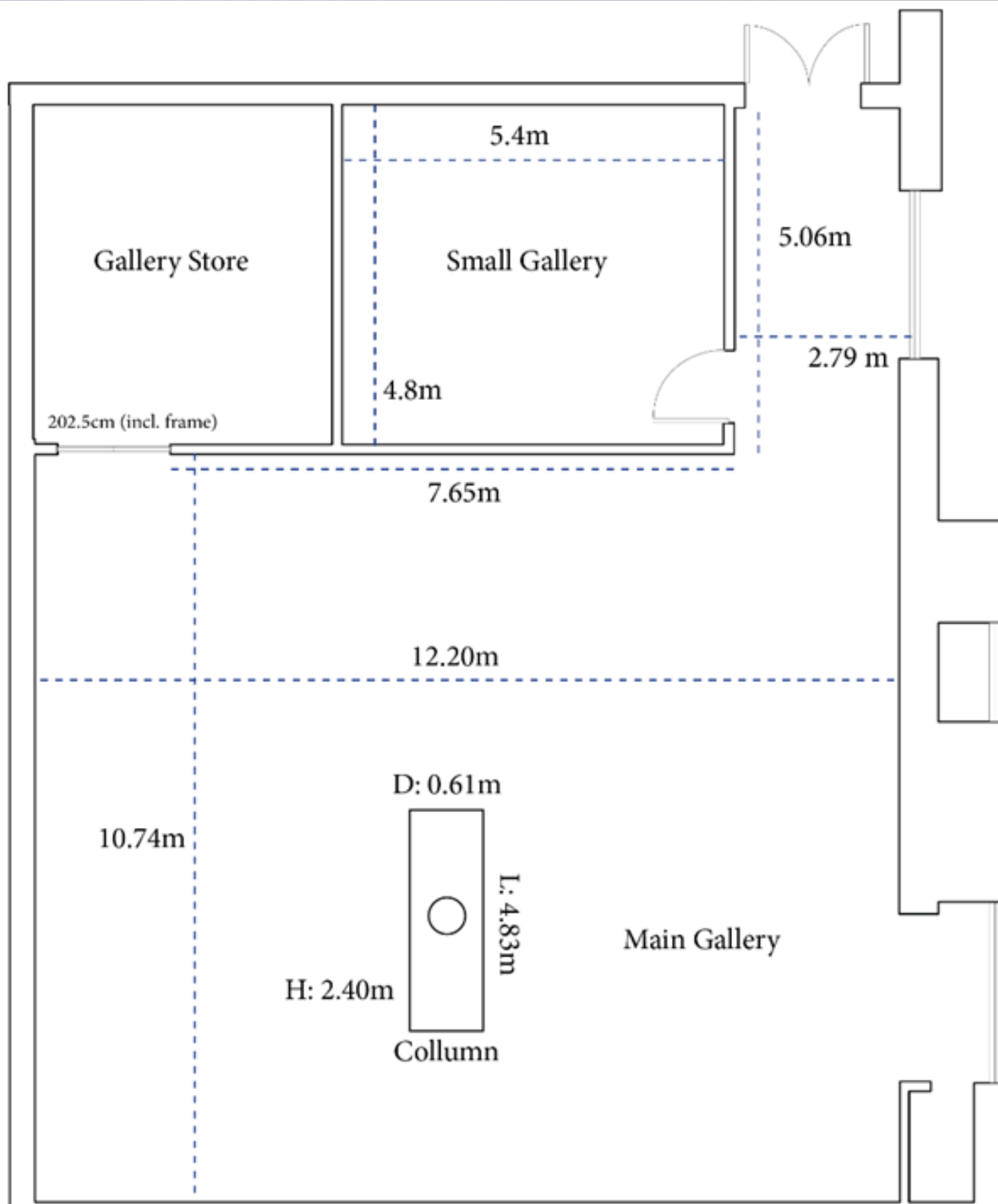





# Gallery pricing

- Large charities / companies: £150/hr, £980/day, £6,000/week
- Ticketed events, local private enterprise: £100/hr, £700/day, £4,000/week
- Small community groups, Tannery artists, small/local charities: £50/hr, £350/day, £2,800/week

Bookings must include two dedicated staff members for Front of House.

Additional staff will be booked subject to availability; charged at £20/hour, minimum four-hour shift.





# Useful information

All hire times include set-up/installation and get-out/de-install, which must be managed solely by the hirer.

Full payment is required at least 2 weeks before the event date – events booked within 2 weeks of the event date will be accepted subject to staff availability.

## Interested?

If you're interested in booking, complete our venue hire form at **[drawingroom.org.uk/hire](https://drawingroom.org.uk/hire)**

If you have further questions or would like to propose a partnership, please email our Commercial Partnerships Manager **[rosie@drawingroom.org.uk](mailto:rosie@drawingroom.org.uk)**





**DRAWING ROOM  
TANNERY ARTS**

[drawingroom.org.uk/hire](http://drawingroom.org.uk/hire)